

# Socket Weld Plug

Part #	Socket Weld Size	A	B	C	Weight
16800500	1/2"	0.875"	1.000"	0.355"	.15 lbs/100
16800750	3/4"	1.085"	1.200"	0.430"	.23 lbs/100
16801000	1"	1.350"	1.475"	0.430"	.31 lbs/100
16801250	1-1/4"	1.695"	1.801"	0.430"	.42 lbs/100
16801500	1-1/2"	1.935"	2.060"	0.430"	.54 lbs/100
16802000	2"	2.426"	2.550"	0.555"	.83 lbs/100

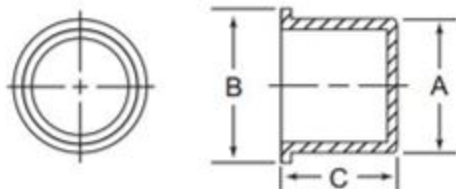

713-463-6339  
sales@m-p.com  
www.m-p.com